

A3

CASINO LOCATION PLAN

14024 SK-24D

g:\2014\2014-024\ds\14024\14024-sk-24d.dwg

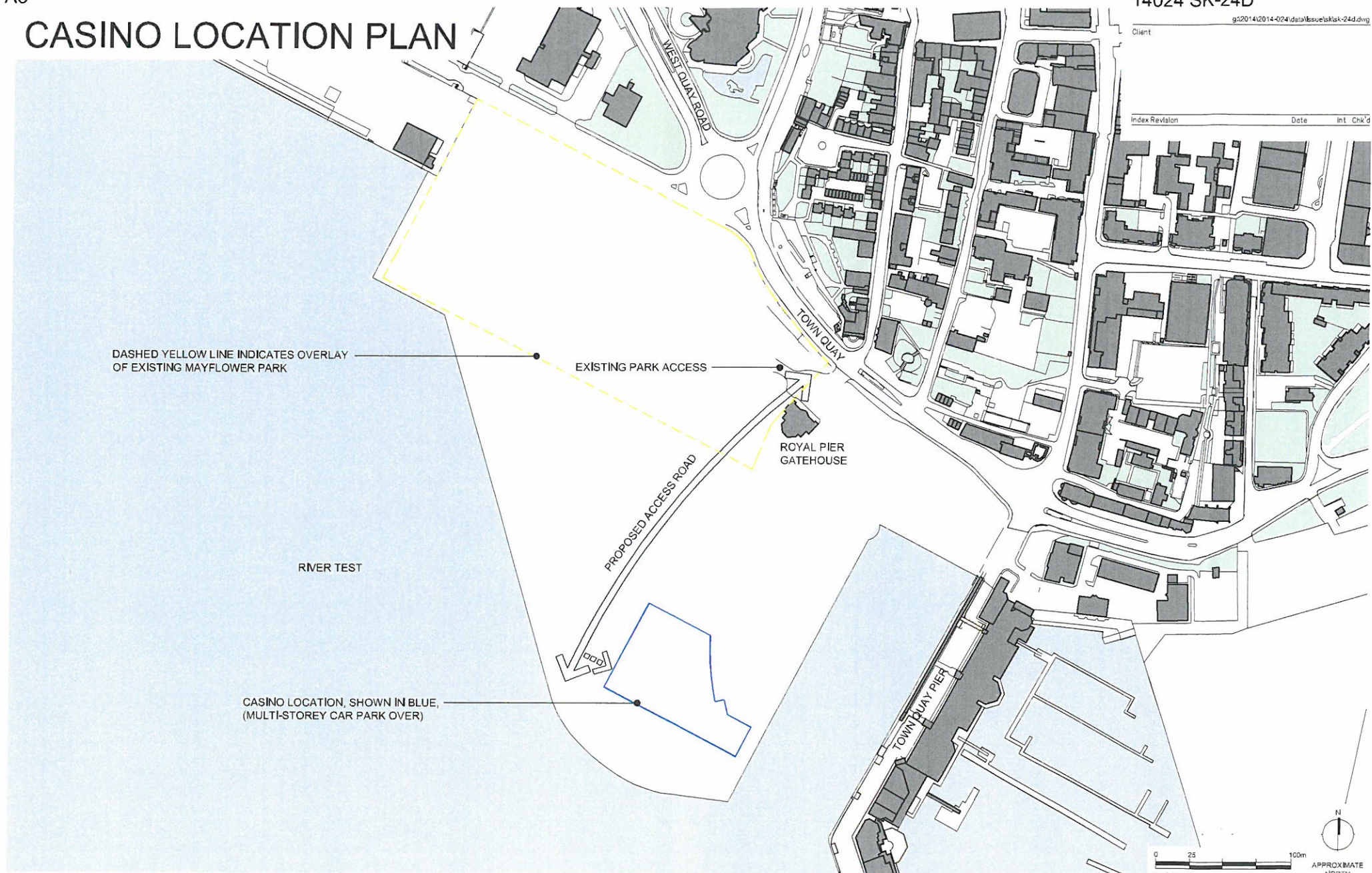

LYONS+SLEEMAN+HOARE | Architects

Nero Brewery, Cricket Green, Hartley Wintney, Hants RG27 8QA
Tel: 01252 844144 Fax: 01252 844800 Web: www.lsharch.co.uk

Job No/Orig No	Rev	Scale	Status
14024 SK-24	D	1:2500	PRELIMINARY
Date	Director	Author	Check
23/06/2014	NR	CW	PC

Job	Drawing
ROYAL PIER WATERFRONT, SOUTHAMPTON	CASINO LOCATION PLAN

NOTE: All figures are approximate and have been measured and expressed in a manner as defined by the current edition of the RICS/BSA Code of Measuring Practice. Figures relate to the current stage of the project and any development decisions to be made on the basis of this information should include due allowance for the increases and decreases inherent in the design and building processes. Reproduced from Ordnance Survey mapping under License Number AH152076 & 100020449

This drawing may be scaled or cross-referenced to the scale bar for plotting. Applications for reuse are not permitted. Do not scale for any other purpose, use figured dimensions only. Subject to site survey and all necessary consents. All dimensions to be checked by user and any discrepancies, errors or omissions to be reported to the Architect before work commences. This drawing is to be used in conjunction with all other relevant drawings.

RECEIVED
01 JUL 2014